



Putzmeister

SAFETY ON THE CONSTRUCTION SITE

EVEN WITH LONGER END HOSES



Putzmeister

Genuine Parts

SPECIAL END HOSE EXTENSION BRACKET

The simple, effective and safe solution for situations in which a longer end hose is needed.

The permitted end hose length of 3–4 metres is insufficient for certain concreting work, in particular filling work. Extending the end hose is only permitted with a corresponding reducer. However, this reducer, when it is even available, is often not suited to the work at hand.

With the patented special end hose extension bracket, Putzmeister is presenting a practical solution for everyday site use. It can be mounted on nearly* every truck-mounted concrete pump in just a few steps and increases the **permitted boom tip load to 350 kg**.

* Not suitable for the BSF 24-4 and 63-5 models





Easy on-site installation

1. Fold the last boom segment before concreting
2. Open the coupling on the last elbow hinge
3. Rotate the elbow by 90° – the concrete will flow from here directly into the end hose instead of the pipeline for the last arm segment
4. Install the special end hose extension bracket and secure it in place with both couplings
5. Attach the extended end hose (the maximum load of 350 kg incl. concrete must not be exceeded)
6. Attach the end hose safety cable
7. Attach the protective sleeve to the couplings (depending on the end hose configuration)



Putzmeister genuine parts – available from your Putzmeister service partner

- For elbows with 180 mm radius: **AN 694524** 15.3 kg
- For elbows with 275 mm radius: **AN 680339** 17.8 kg

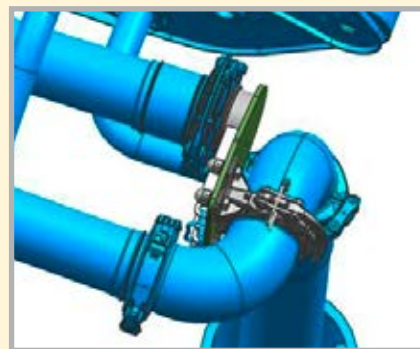

Distributed by:

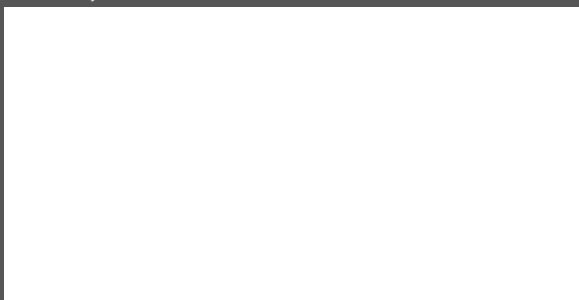

 **Putzmeister**

Putzmeister Concrete Pumps GmbH

Max-Eyth-Straße 10 · 72631 Aichtal / Germany

Tel. +49 (7127) 599-0 · Fax +49 (7127) 599-520

pmw@putzmeister.com · www.putzmeister.com